

# DuraSquare Washbasin, furniture washbasin # 2353100040 / 2353100041 / 2353100044 / 2353100070

| < 1000 mm > |

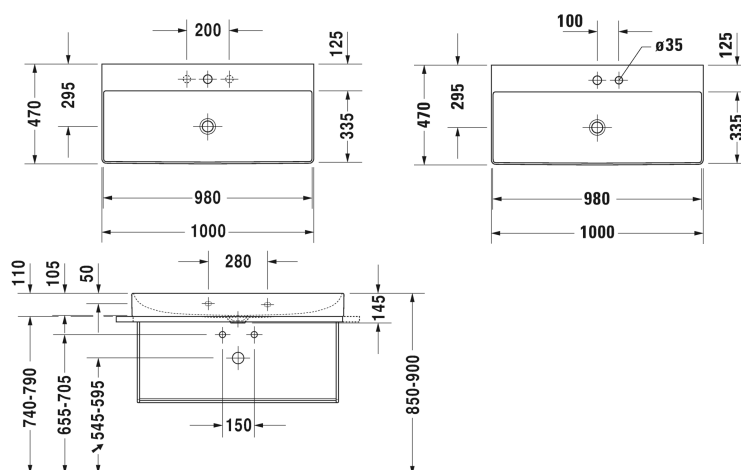
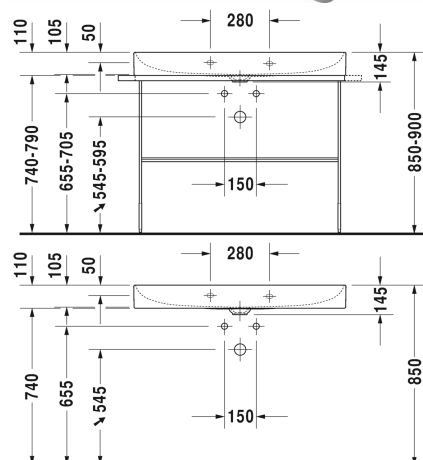

Washbasin, furniture washbasin	Dimension	Weight	Order number
without overflow, with tap platform, ceramic covered slotted waste included, underneath glazed, 1000 mm			
<b>Colors</b>			
00 White Alpin			
<b>Variant</b>			
● ●	1000 x 470 mm	22.900 kilogram	2353100040
●	1000 x 470 mm	22.900 kilogram	2353100041
● ● ●	1000 x 470 mm	22.900 kilogram	2353100044
☒	1000 x 470 mm	22.900 kilogram	2353100070
<b>Infobox</b>			
Colours for glass inserts consistent with paint surfaces for furniture page XXX, Metal console: Towel rail can be mounted right or left , Made from DuraCeram			
Sanitary ceramics with the special WonderGliss surface finish will remain clean and attractive-looking for a long time to come. When ordering WonderGliss please add a "1" as eleventh digit to the model number.			

## DuraSquare Washbasin, furniture washbasin # 2353100040 / 2353100041 / 2353100044 / 2353100070

|< 1000 mm >|

Accessory			
Towel rail square tube 14 mm, for washbasin # 235310	941 mm	0.700 kilogram	003119
Design Siphon		1.500 kilogram	005036
Suitable products			
Metal console standing ** height adjustable +50 mm, fixings included, for washbasin # 235310, Towel rail right/left, reversible, 1065 x 451 mm	1065 x 451 mm		003103
Metal console wall mounted ** fixings included, for washbasin # 235310, Towel rail right/left, reversible, 1065 x 451 mm	1065 x 451 mm		003104
Glass inserts safety glass, for metal console # 003103, 003104, 970 x 380 mm	970 x 380 mm		009965
Vanity unit wall-mounted 1 pull-out compartment, 984 x 460 mm	984 x 460 mm		XS4063
Vanity unit wall-mounted 2 drawers, upper drawer including cut-out for siphon and siphon cover, 984 x 460 mm	984 x 460 mm		XS4163
Vanity unit floor-standing 2 pull-out compartments, integrated base frame legs with height adjustment, 984 x 460 mm	984 x 460 mm		XS4444

*All drawings contain the necessary measurements which are subject to standard tolerances. They are stated in mm and are non-binding. Exact measurements, in particular for customised installation scenarios, can only be taken from the finished piece.*